

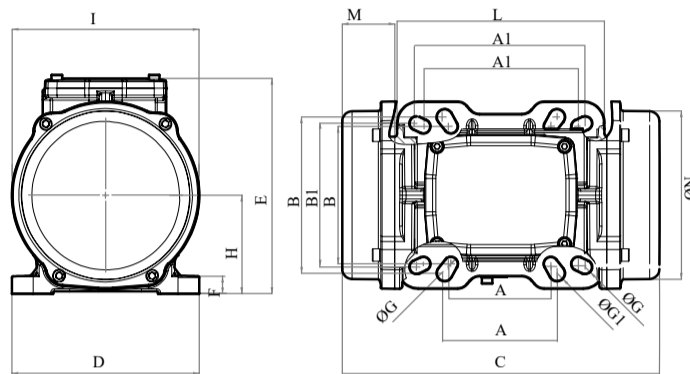

MVE 200/15E-30A0 (EE40020030A0JA0000)

3 PH - 4 poles - 1500 RPM - 220-240/380-415 V - 50 Hz

| Working moment [Kg*cm] | Unbalance [Kg*cm] | Centrifugal force [Kg] | Nominal voltage [V] | Input power [kW] | Current [A] | Power factor | Ia/In |
|------------------------|-------------------|------------------------|---------------------|------------------|----------------------|--------------|-------|
| 15,44 | 7,72 | 194 | 220-240/380-415 | 0,12 | Δ 0,85 Y 0,49 | 0,35 | 2,2 |







*Technical drawings are illustrative purposes only, please refer to 2D/3D drawings available on "FINDER" app.
Contact us for more information.

| OVERALL DIMENSIONS [mm] | | | | | | | | | | | | | | | | |
|-------------------------|-------|---------|---------|---------|----|----|--------------|-----|-----|-----|----|----|-----|-----|----|-----|
| Weight [Kg] | A | A1 | B | B1 | G | G1 | Holes number | C | D | E | F | H | I | L | M | N |
| 11,8 | 80-90 | 124-135 | 110-125 | 110-115 | 11 | 13 | 4 | 274 | 150 | 173 | 15 | 79 | 150 | 166 | 52 | 134 |

| TECHNICAL FEATURES | | | | | | |
|--------------------|------------------|---------|------------------------|----------------------|------------|-------------|
| Type of grease | Greased for life | Screw | Washer | Clamping torque [Nm] | Cable type | Cable gland |
| / | Yes | M10-M12 | 10,5 x 20 - 13 x 24 mm | 45-80 | 4G2.5 80°C | M20 80°C |

| BEARINGS LIFE HOURS | | | | |
|---------------------|---|----------|---------|---------|
| Bearing model | Type | 100% C.F | 80% C.F | 50% C.F |
| 6304 2Z |  | 27831 | 54358 | >100000 |

| CERTIFICATION | |
|--|--|
| ATEX II2 D Ex tb IIIC Tx Db IP66 IECEx Ex tb IIIC Tx Db IP66 CLASS II DIV.2 GROUP F,G T4 Ex tb IIIC Tx Db IP66 [Tx Size Micro,10-30:100°C - Tx Size 40-91:135°C] CONFTO UL1004-3, UL1004-1,UL 60079-0,UL60079-31 CERT. CSA C22.2 No.100,CSA C22.2 No.77, CSA C22.2N.60079-0,CSA C22.2N. 60079-31 T.Amb -20/+40°C |      |

REV:1-22/05/2019

Dimension with coarse degree of accuracy related to UNI 22768/1 Rights reserved to modify technical specifications.